



The Anglican Parish of St. Mark and St. Philip

1802 - 33 Ave. SW, Calgary, Alberta

Phone: 403-244-0198

Email: office@parishofstmstp.com

www.parishofstmstp.com

... encouraging persons in their faith and their calling

Dear Fellow Parishioners,

Loving our neighbour as our self in a pandemic includes recognizing that our actions have consequences that affect many more people than the few that can gather for worship.

A couple of weeks ago Anglican parishes were able to apply to the Diocese to reopen for public worship services. To make this request, St. Mark & St. Philip had to demonstrate to the Archbishop that we had plans in place to adhere to all current Provincial and Alberta Health Services guidelines for Places of Worship and all guidelines specific to the Diocese of Calgary. We also agree to follow the guidelines that are followed by our landlord, Holy Martyr Perter the Aleut Orthodox Church.

Archbishop Greg accepted our application and we will reopen with joy for worship on Sunday, September 20th, 2020 for the 12:30 pm service. Unfortunately, the 8 am service will not return for now as there is insufficient time to sanitize before the beginning of the Holy Martyr service at 9:45 am. For those who do not wish to return at this time, the service will be posted live to Facebook as Padi Joey has been doing these last months, but now from our church and not his home office.

We are unable to go back to the way things were. Covid-19 is still with us and likely will be for many months to come. The risk of transmitting Covid-19 is still with us, but if we follow the protocols we have been given, we can return to a form of public worship that recognizes the current and ongoing reality, and adapt for it as safely as possible. This will be our 'new normal'.

General Guidelines

First, we must answer the AHS screening questions (Appendix A) before entering the church. This checklist will be posted on the front door of the church. Please do not enter the church if you answer YES to any of the questions, or if you feel ill in any way.

Second, always remain 2 meters (6 feet) apart from other people not in your family/cohort. Social gathering before and after church is discouraged on church property.

Third, non-medical face masks are mandatory and must always be worn while you are in church. You are encouraged to bring your own, but they will be provided for those who don't have them. Children 8 and under are not required to wear a mask, but must be supervised at all times in order to maintain the 2m distance from all others.

Fourth, please use the hand sanitizer provided at the entrance.

Fifth, always sneeze or cough into your elbow.

General Procedure

Arrival and Seating

- Arrive on time - door will be unlocked at 12:15 pm and locked again at the beginning of the service.
- Upon arrival, check in with the doorkeeper at the front door of the church on 33rd Avenue.
- At check in, all names of attendees will be recorded and kept confidential. This list will be kept for 2 weeks as required by AHS, then shredded.
- There will be a collection plate located at the entry to the main aisle (and also on the Credence Table beside the Altar for after the service). Collection during the service is prohibited. Please use your own envelope as all books, pamphlets and papers were required to be removed from the pews.
- Single use service booklets will be provided each Sunday. When entering, please fill the pews from the front to the back. Pews have been designated for sitting (see Appendix B). Families of people isolating together can sit together between the taped lines up to 5 people in a pew.

Singing and Sign of the Peace

- Singing is forbidden at this time under current provincial guidelines.
- There will be no physical contact at the Sign of the Peace. Please stay in your pew & nod/bow to others.

Receiving Holy Communion

- Padi Joey will wear a non-medical mask during the distribution of Holy Communion.
- Only Communion wafers will be distributed, no wine.
- Holy Communion may only be received in hand.
- Come up for Communion, alternately by pews, in single file and physically distanced as per the blue lines in the aisle (children may be with parents) (see Appendix B).
- Keep mask on while receiving communion, then step either left or right to the taped X on either side of Padi Joey. Pull down or unhook one side of your mask, consume communion wafer, reattach mask touching the sides only, re-sanitize hands and return to your pew.

Departure

- At end of services departure will only be through the front of the church and out the door onto 17th Street.
- All visiting must be done outside the church, Do not loiter in the lobby.

Washroom

- Only the upstairs washroom will be open for use at this time. Use exit at the front of the church.
- If you must use the washroom, please do the following:
 - ◆ Wipe down all surfaces that you have touched with either the Lysol wipes, or paper towel and sanitizing spray that are provided in the washroom.
 - ◆ Wash your hands for 20 seconds with hot soap and water,
 - ◆ Leave the door propped open for the next person
 - ◆ Parents must accompany young children to the washroom and clean up after them.

We acknowledge that these guidelines will affect your experience of the service and may be difficult for some. In the spirit of Christian charity, we ask that you abide by them for the sake of the health and safety of your brothers and sisters in Christ. Thank you for your cooperation. May the grace of our Lord Jesus Christ, the love of God, and the communion of the Holy Spirit be with us all.

Padi Joey, Leslie Miles (People's Warden) and Marilyn Croot (Incumbent's Warden)

Appendix A

COVID-19 ALBERTA HEALTH DAILY CHECKLIST

Please do not enter the church if you answer yes to any of the following:

1. Do you or your child have any of the following symptoms?
 - a. Fever
 - b. Cough
 - c. Shortness of Breath / Difficulty Breathing
 - d. Sore throat
 - e. Chills
 - f. Painful Swallowing
 - g. Runny Nose / Nasal Congestion
 - h. Feeling Unwell / Fatigued
 - i. Nausea / Vomiting / Diarrhea
 - j. Unexplained loss of Appetite
 - k. Loss of sense of Taste or Smell
 - l. Muscle / Joint aches
 - m. Headache
 - n. Conjunctivitis (commonly known as Pink Eye)
2. Have you or your child travelled outside Canada in the last 14 days?
3. Have you or your child had unprotected* face to face contact within 2 meters/6 feet with someone who has travelled outside Canada in the last 14 days and is ill (any of the above symptoms)?
4. Have you or your child had unprotected* face to face contact within 2 meters/6 feet with in the last 14 days with someone who is ill (any of the above symptoms)?
5. Have you or your child or anyone in your household been in close unprotected* contact in the last 14 days with someone who is being investigated or confirmed to be a case of COVID-19?

* **“unprotected” means close contact without appropriate personal protective equipment.**

Appendix B

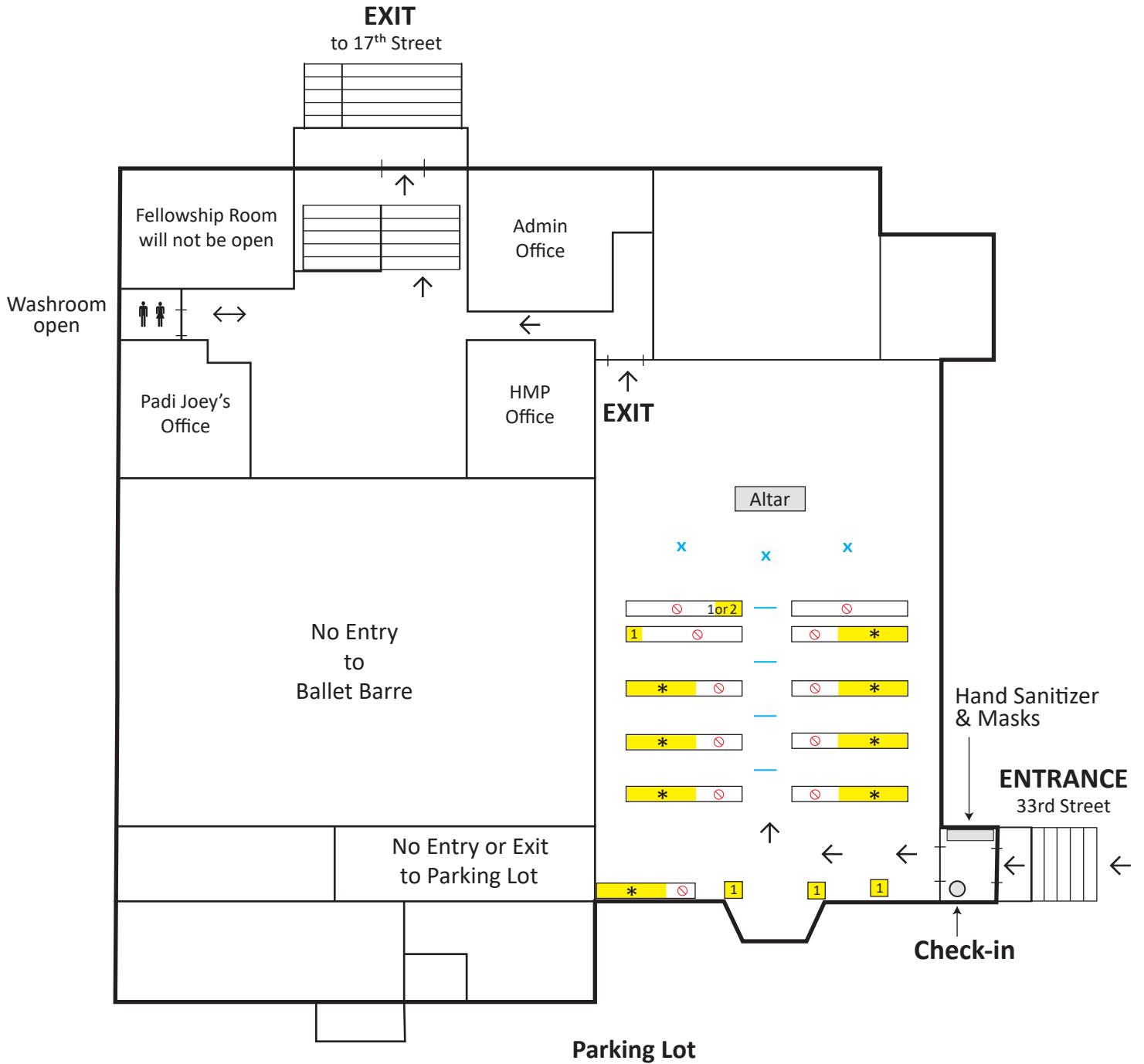

* Pew seating - 1 or 2 people, or up to 5 in a family
Capacity: 22 to 46 people